

### 說明 NOTES

此圖根據第 SHO-G02 號圖則制訂，以黃色標明暫時封閉毗鄰小蠔灣車廠的順朗路路段，及以綠色標明暫時封閉毗鄰小蠔灣車廠的北大嶼山公路路段。

THIS DRAWING IS PREPARED BASED ON DRAWING NO. SHO-G02 AND IS INTENDED TO SHOW THE TEMPORARY CLOSURE OF THE SECTION OF SHUN LONG ROAD ADJACENT TO THE SIU HO WAN DEPOT (HIGHLIGHTED IN YELLOW), AND THE TEMPORARY CLOSURE OF THE SECTION OF NORTH LANTAU HIGHWAY ADJACENT TO THE SIU HO WAN DEPOT (HIGHLIGHTED IN GREEN).

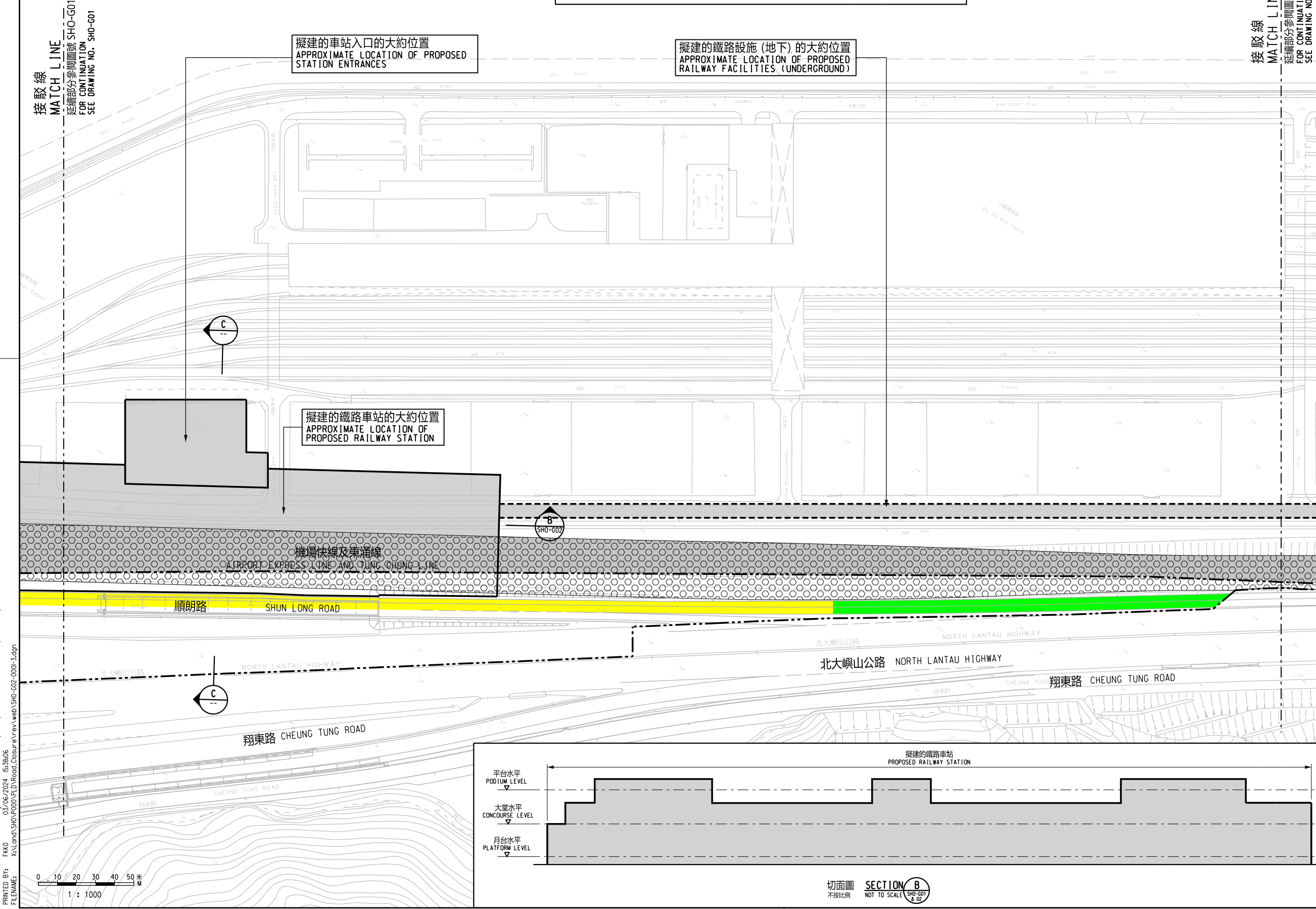
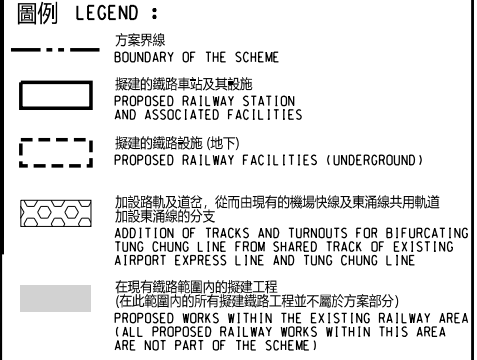

一般說明 GENERAL NOTES

1. 有關一般說明參閱圖號 SHO-G01.  
FOR GENERAL NOTES, REFER TO DRAWING NO. SHO-G01.

修訂表  
TABLE OF AMENDMENTS

修改 REV	日期 DATE	繪圖 BY	核對 SUB	負責 APP	說明 DESCRIPTION

SIGNED

溫健德 WAN KIN HUNG, DENNIS

批准發出  
APPROVED FOR ISSUE

03/06/2024

發出日期 DATE OF ISSUE

圖則名稱 DRAWING TITLE

鐵路條例(第519章)  
位於小蠔灣的鐵路車站  
暫時封閉毗鄰小蠔灣車廠的順朗路及北大嶼山公路  
路段

RAILWAYS ORDINANCE (CHAPTER 519)  
RAILWAY STATION AT SIU HO WAN  
TEMPORARY CLOSURE OF SECTIONS OF SHUN LONG ROAD  
AND NORTH LANTAU HIGHWAY ADJACENT TO THE SIU HO  
WAN DEPOT

圖號 DRAWING NO.

SHO/G02/0001/3

比例 SCALE

1:1000 (A1)  
或如圖示  
AS SHOWN

香港特別行政區政府  
THE GOVERNMENT OF THE HONG KONG  
SPECIAL ADMINISTRATIVE REGION

路政署  
HIGHWAYS DEPARTMENT

鐵路拓展處  
RAILWAY DEVELOPMENT OFFICE