

說明 NOTES

此圖根據第HSK-G02號圖則制訂，以黃色標明將暫時封閉的部分亦園路路段，以藍色標明將暫時封閉的位於亦園路以北的未命名道路路段及毗鄰行人路，及以綠色標明將暫時改動的位於亦園路以南的未命名道路。

THIS DRAWING IS PREPARED BASED ON DRAWING NO. HSK-G02 AND IS INTENDED TO SHOW THE TEMPORARY PARTIAL CLOSURE OF THE SECTION OF YICK YUEN ROAD (HIGHLIGHTED IN YELLOW); THE TEMPORARY CLOSURE OF THE SECTION OF THE UNNAMED ROAD AT THE NORTH OF YICK YUEN ROAD AND ITS ADJACENT FOOTPATH (HIGHLIGHTED IN BLUE); AND THE TEMPORARY ALTERATION OF THE UNNAMED ROAD AT THE SOUTH OF YICK YUEN ROAD (HIGHLIGHTED IN GREEN).

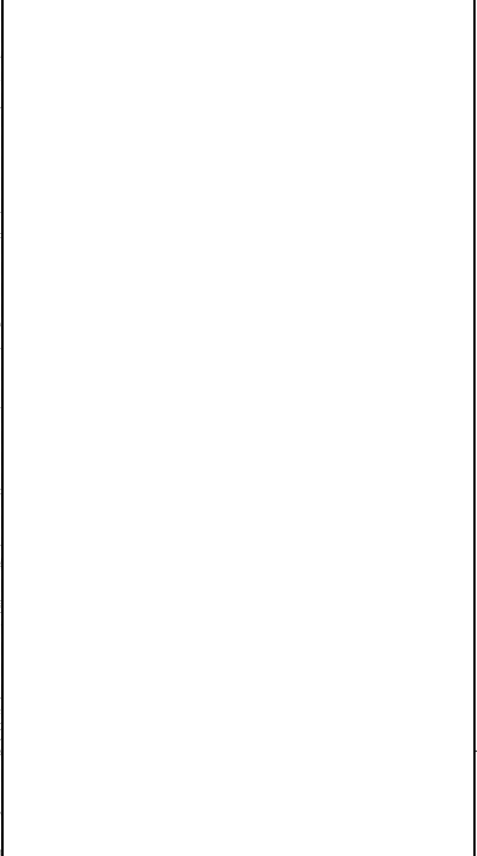
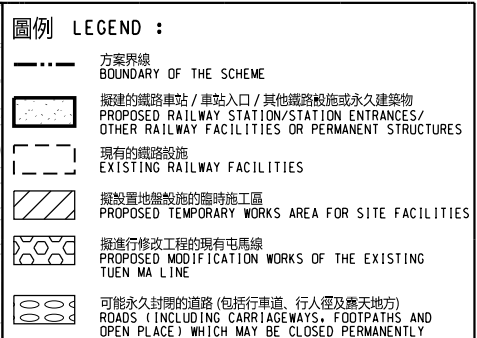
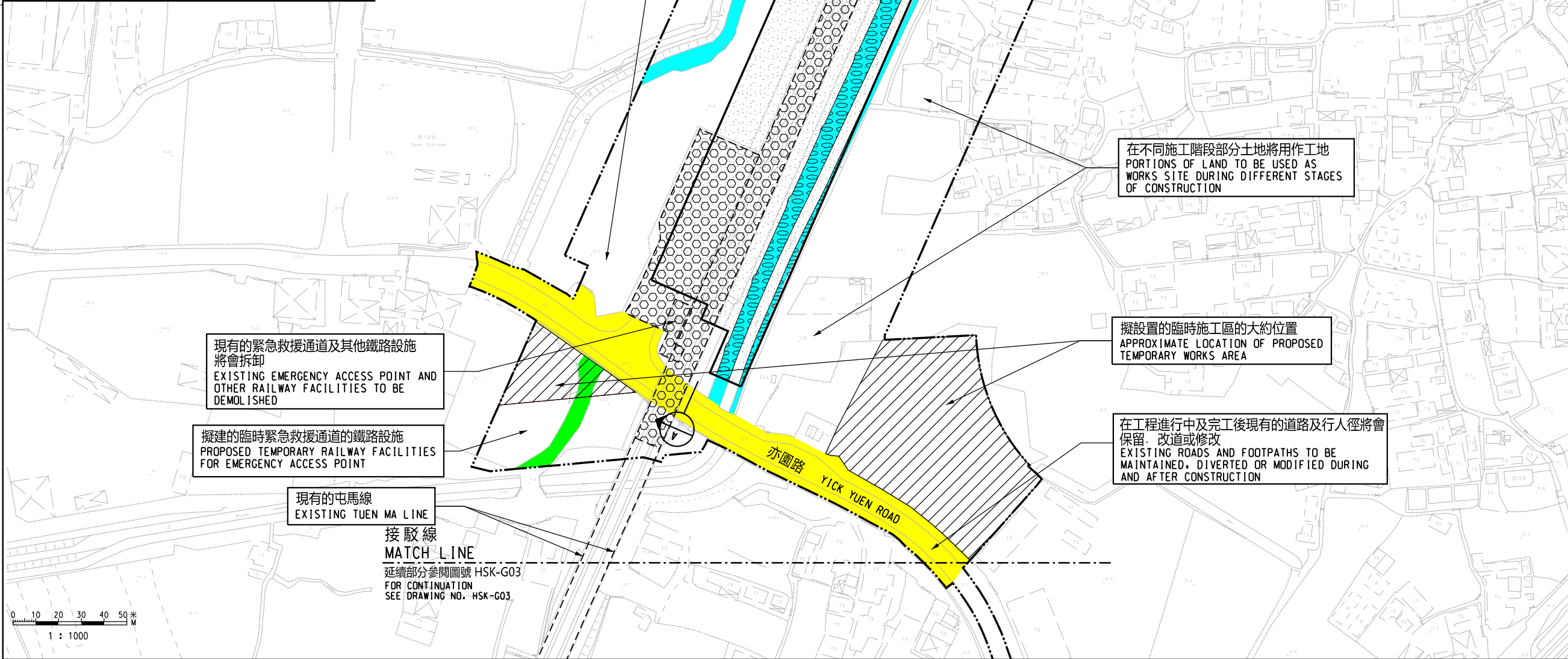

一般說明 GENERAL NOTES :

1. 有關一般說明參閱圖號 HSK - G01.
FOR GENERAL NOTES, REFER TO DRAWING NO. HSK-G01.

修訂表 TABLE OF AMENDMENTS					
修改 REV	日期 DATE	繪圖 BY	核對 SUB	負責 APP	說明 DESCRIPTION

SIGNED

甘家元 KAM KA YUEN, EDDY
路政署
總工程師/
北部都會區鐵路部 (1)
CHIEF ENGINEER/
NORTHERN METROPOLIS RAILWAYS DIVISION (1)
HIGHWAYS DEPARTMENT

27/11/2025
發出日期 DATE OF ISSUE

圖則名稱 DRAWING TITLE
**鐵路條例 (第519章)
位於洪水橋的鐵路車站**
暫時封閉亦園路，及位於亦園路以北的未命名道路路段及毗鄰行人路；以及暫時改動位於亦園路以南的未命名道路

RAILWAYS ORDINANCE (CHAPTER 519)
RAILWAY STATION AT HUNG SHUI KIU
TEMPORARY CLOSURE OF SECTIONS OF YICK YUEN ROAD, AN UNNAMED ROAD AT THE NORTH OF YICK YUEN ROAD AND ITS ADJACENT FOOTPATH; AND TEMPORARY ALTERATION OF AN UNNAMED ROAD AT THE SOUTH OF YICK YUEN ROAD

圖號 DRAWING NO.
HSK/G02/0001/1

比例 SCALE
**1:1000 (A1)
或如圖示
OR AS SHOWN**

香港特別行政區政府
THE GOVERNMENT OF THE HONG KONG
SPECIAL ADMINISTRATIVE REGION

路政署
HIGHWAYS DEPARTMENT

鐵路拓展處
RAILWAY DEVELOPMENT OFFICE